

### Standard features

- Waterproof
- Impact resistant
- Conditional lifetime guarantee
- Crushproof
- Dustproof
- Powerclaw™ latching system
- Soft grip foldable handle
- Lightweight NK-7™ resin
- Padlockable
- 100% stainless steel hardware
- High performance gasket
- Automatic pressure release valve
- Molded-in bezel system
- Integrated lid stay
- Stackable
- Meets airline carry-on regulations

### Case specifications

<b>Exterior dimensions</b>	L14.3" x W11.1" x H4.7" L363mm x W282mm x H120mm
<b>Interior dimensions</b>	L13.2" x W9.2" x H4.1" L336mm x W234mm x H104mm
<b>Weight (empty)</b>	3.0 lbs   1.4 kg
<b>Lid depth</b>	1.3"   33mm
<b>Base depth</b>	2.8"   71mm
<b>Material</b>	lightweight NK-7™ resin
<b>Max buoyancy</b>	17 lbs   7.8 kg
<b>Temperature range</b>	Min -20°F (-29°C) Max 140°F (60°C)
<b>Airline carry-on</b>	yes
<b>Watertight (IP67)</b>	yes
<b>Warranty</b>	conditional lifetime guarantee

### Available options

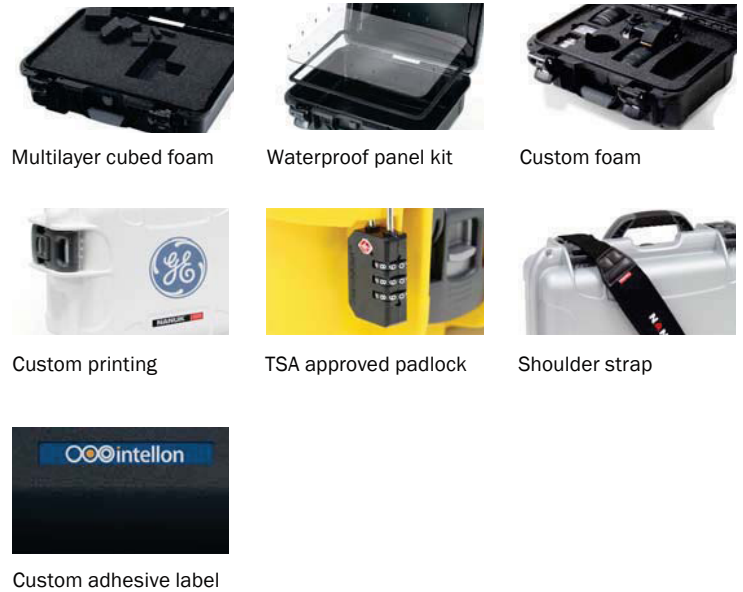

### Certifications

testing in progress

<b>ATA 300</b>	Impact test
<b>ASTM D4169</b>	Falling rain - Vibration - Drop tests
<b>MIL-STD-810F</b>	Immersion test
<b>IP 67</b>	Ingress protection tests (dust & immersion)

### Packaging specifications

<b>Quantity per pack</b>	1
<b>Pack dimensions</b>	L14.6" x W4.8" x H11.7" L371mm x W122mm x H297mm
<b>Pack weight (no foam)</b>	3.5 lbs   1.6 kg

### Available colors



### Masterpack specifications

<b>Items per masterpack</b>	4
<b>Masterpack dimensions</b>	L24.4" x W18.0" x H10.9" L620mm x W457mm x H277mm
<b>Masterpack weight</b>	15.5 lbs   7.0 kg